

COWTM WASHER



INSIDE: *They're only 3" tall, but they pack a wallop in profit! These precision wash heads cut water use, wash time and maintenance while reducing injuries and stress on the cows.*

ALSO: *A Dairyman's Concise Guide to Wash Pen Installation*

COW WASHER

Cuts Costs

6

Ways



1. Cuts water use.

Reduced gallons per minute and wash cycle times can save 1000's of gallons per day, compared to other sprinklers.

2. Cuts wash time.

Patented design sprays water that soaks through to the hide faster.

3. Reduces injuries.

No guards needed. Small, round profile can't catch on the cow's legs or udder.

4. Cuts maintenance.

Can be serviced in seconds from the top, without removal from the riser. Machined parts withstand abuse, can't rust or corrode.

5. Reduces cow stress.

Gentle fan spray of large droplets - never a hard stream - keeps cows stress-free and receptive.

6. They clean better!

Cow Washer handles the worst caked-on mud. Water droplets soak through to the hide instead of hitting with such force as to bounce off the cow.

Water Use?

COW WASHER

Washes Away the Competition!

Water Use Comparison (GPM)

PSI	25	30	35	40	45	50
Cow Washer	3.8	4.0	4.3	4.5	4.7	4.9
Rainbird	4.0	4.6	5.0	5.4	5.8	6.3
Weather-Tec	4.7	5.2	5.6	6.0	6.4	6.9
Rain Jet	4.3	4.9	5.3	5.6	5.9	6.5
Cow Showers	4.5	—	—	—	—	8.0

Maintenance

Most Cow Washer installations experience years of trouble free service because the water they use is relatively sand free. Dairies with a lot of sand in the water supply must expect to perform maintenance more often. However, these high-maintenance installations are usually justified by the increased production from herds washed by the Cow Washer.

**New Super
Water Saving
Model
Available!**

Reduced flow
sprinkler cuts the
standard flow rate
by 30%! See page
6 for ordering
information.

Specifications

- ★ **Materials:** Solid aluminum, brass and engineered plastic. Body and cap are machined from 6061-T6 aluminum and anodized for long life.
- ★ **Weight:** 3/4 lb.
- ★ **Height:** 3"
- ★ **Base Threads:** 1-1/4" FPT
- ★ **Spray Pattern:** 21' radius and no higher than 38" off the wash pen floor. Available in full circle, half circle and quarter circle models.
- ★ **Operating Pressure:** 35 to 55 PSI
- ★ **Nozzle:** Nozzle pops up with water pressure and has specially designed inserts that break the water into large droplets.
- ★ **No guard or bonnet required.**

Technical Assistance!

Technical assistance is just a phone call or mouse click away. Call our toll free number 24/7. The voice mail box is checked regularly during non-business hours. Or, visit our web site to obtain answers to general and technical questions.

1-800-645-7458

www.cowwasher.com

Warranty

Cow Washer (hereafter “CW”) warrants to the original end user that Cow Washer wash heads (hereafter “the equipment”) will be free from defects in material and workmanship for a period of 90 days from the date of purchase. This warranty is conditioned on the accuracy of information furnished by the buyer to the seller or CW at any time, but particularly at the time of purchase, delivery or installation.

CW warrants that the equipment will fulfill the mechanical function it is designed to perform, but due to the wide variation in farm animals, management practices and other conditions beyond the control of CW, no specific level of performance is guaranteed.

Excluded from this warranty are damages caused by late delivery, ordinary wear and tear, wear caused by sand particles (as evidenced by excessive erosion of parts), water pressure exceeding 60 PSI, damage to the head, body or lid from installation or disassembly using improper tools, misuse, abuse or improper handling or operation of the equipment by the purchaser or any third party.

CW reserves the right to change the product design and/or materials without notice.

THE SELLER AND CW MAKE NO OTHER WARRANTY FOR THE EQUIPMENT OR THE SYSTEM IN WHICH IT IS USED, EXPRESS OR IMPLIED, INCLUDING BUT NOT LIMITED TO THE IMPLIED WARRANTIES OF MERCHANTABILITY AND FITNESS FOR A PARTICULAR PURPOSE.

COW WASHER

Unlike many wash heads, the Cow Washer is not an adapted lawn sprinkler. It has been carefully engineered to do just one thing well: To wash cow udders quickly and efficiently using an optimum amount of water. The Cow Washer's precision parts are ingeniously packed into a 2" x 3" cylinder with rounded edges that are easy on the cows. **There are plenty of sprinklers, but only one Cow Washer.**

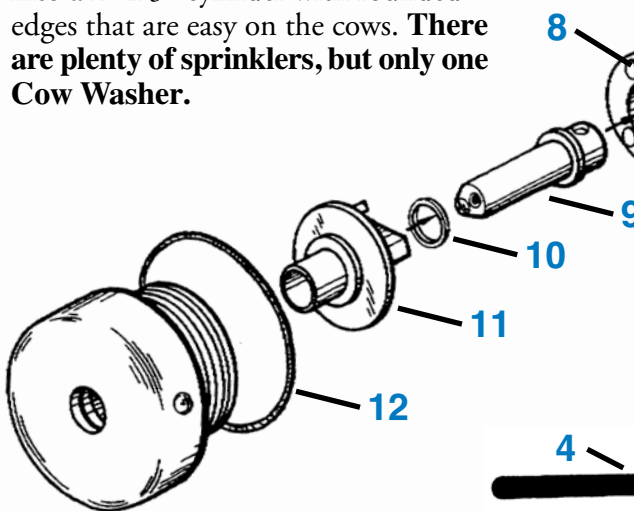

#	Description	P/N
1	Full Circle Cap	CW2
2	Half Circle Cap	CW9
3	Quarter Circle Cap	CW10
4	2-1/4" Spanner Wrench	CW-SW
5	Body	CW1
6	Cup (Sleeve)	CW3
7	Bottom Cam (with Drive Buttons)	CW4

Complete Sprinklers:

Full Circle (P/N CW1993)

Quarter Circle (P/N CW1993-25)

Half Circle (P/N CW1993-50)

R: The Inside Story

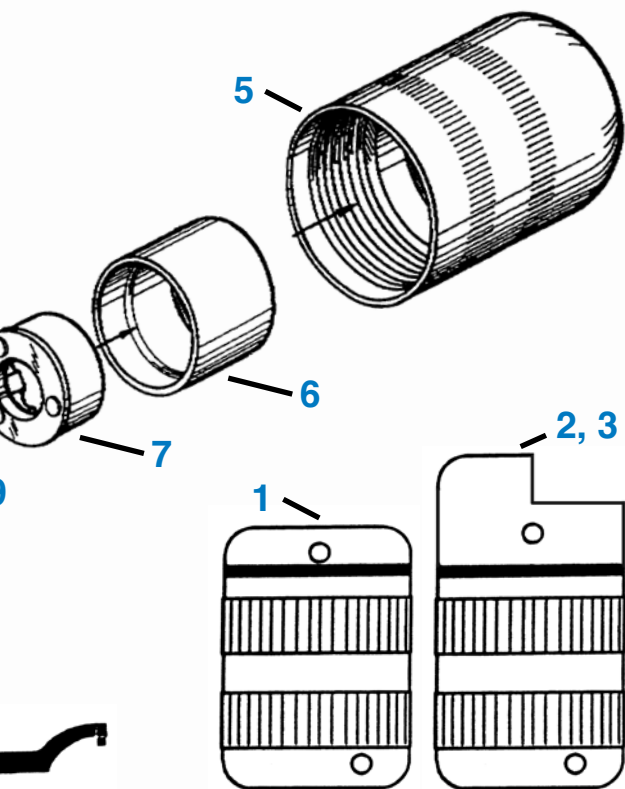

#	Description	P/N
8	Drive Buttons (set of 3)	CW8
9	Spindle	CW6
10	Gasket	CW11
11	Top Cam	CW5
12	O-ring	CW12
13*	Repair Kit**	CW354
14*	Cap with Pressure Gauge	CW15

* Not shown

** Includes: Sleeve, Top Cam, Bottom Cam, Gasket and O-ring.

The Dairyman's Concise Guide to Wash Pen Construction*

Some Principles of Good Milking Parlor Practice

Research has proven the value of wash pens. Dirty cows increase prep time an average of 16 seconds per cow, and use of a wash pen increases throughput by 8% - 21%, depending on parlor size. In designing your wash pen and drip pen, keep these facts in mind:

- Cows should enter the parlor straight ahead and turn when exiting.
- Be sure there is good lighting in both the wash pen and the parlor. Cows don't like the contrast of going from a lighted to a darker area.
- Crowd-gates between the wash pen and drip pen can improve throughput by as much as 5%.
- Herds that are milked 3x daily should not be held in the wash/drip pens for more than one hour per milking.

Cows Per Hour in Parallel Parlors

Parlor Capacity	24 cows	32 cows	40 cows
With Wash Pen	96	161	195
No Wash Pen	88	149	160

Building a Better Wash Pen

Design the wash pen to allow 14 sq. ft. for each cow. Cows are stressed by crowding, and stressed cows require longer milking times to produce less milk. If cows are allowed about 13-1/2 - 14 square feet of wash pen space apiece, they are more likely to be clean and placid when they enter the parlor.

* © 2007 CW

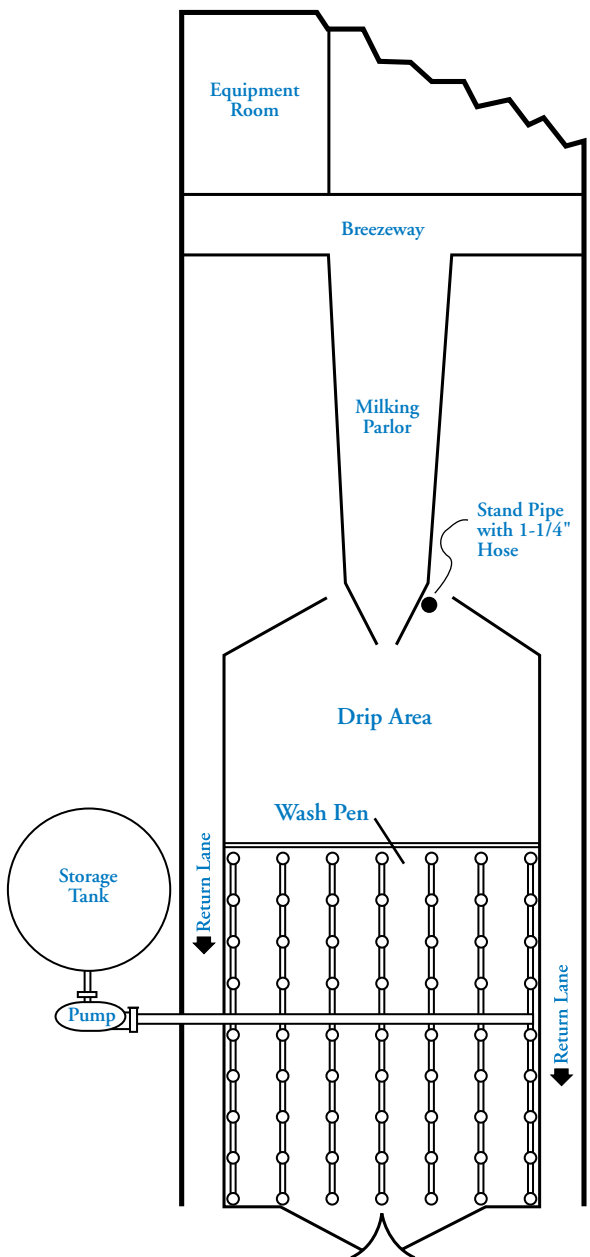

In laying out wash heads, keep each side row as close as possible to the fence. *(If a cow gets between the side row and the fence, she will be washed on one side only!)* Space wash heads apart on a 5' x 5', 5' x 6', or 5' x 7' grid, whichever provides the most efficient layout.

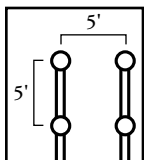

Run water lines under the wash pen floor or anchor securely to concrete. The pipe grid should be laid on a bed of sand under a concrete slab.

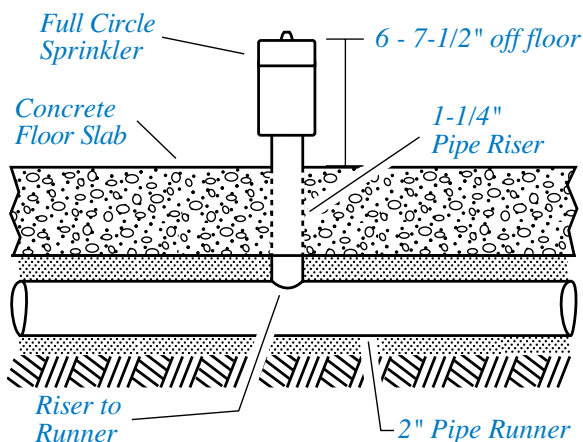

When retrofitting an existing floor, pipes must be welded to brackets which raise them off the floor and provide a means of anchoring them to the concrete.

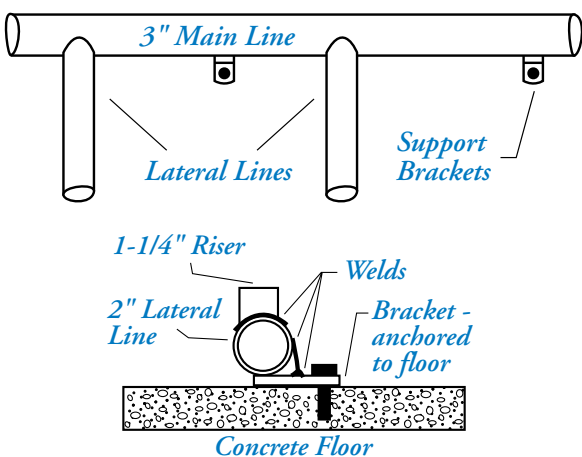

To prevent returning cows from being sprayed with water, weld sheet metal to the fence to within 6" of the floor, or fit side-rows with 1/2-circle wash heads. Use 1/4-circle wash heads in wash pen corners.

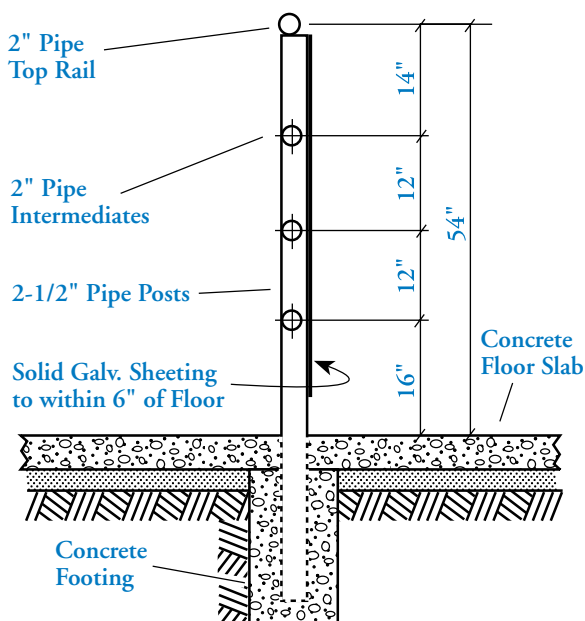

Determining the size of the water pump required by the wash pen involves calculating pipe size, length of pipe runs, number and type of fittings, and the number of wash heads. Use the following chart to select the proper water pump.

Water Pump Selection*

Capacity	Wash Heads	GPM Req.	Pump HP
50-86 cows	25-40	125-200	7-1/2
86-118 cows	40-55	200-275	10
118-161 cows	55-75	275-375	15
161-214 cows	75-100	375-500	20

* Based on 30 sq. ft. spacing of wash heads and 14 sq. ft. of wash pen space per cow.

*Note! To maintain proper water pressure at the wash heads (35-50 PSI), a flow control valve with a water return line must be installed in the main service line between the pump and the wash pen. **Failure to install a water return line will cause back pressure on the pump.** The operating pressure at the wash heads can be determined by taking a water gauge reading at the farthest point from the water pump in the wash pen. This gauge is available from Cow Washer.*



COW WASHER

*Manufactured & Assembled in the USA
Serving the Dairy Industry Since 1993*

Email: info@cowwasher.com

Web: www.cowwasher.com

**Call toll free
1-800-645-7458**